

## Shut-off dampers

# FLX-DAS



### Description

FLX-DAS shut-off dampers are a good choice when the ductwork closure does not have to be fully airtight. This product is rather intended for regulation of the airflow. The damper closure angle is between 0 and 90°.

The FLX-DAS shutoff dampers are made from galvanized steel sheet. Available also damper version made from stainless steel on special request.

#### Product code example

Product code: **FLX-DAS - 75**

type \_\_\_\_\_  
 Ød<sub>1</sub> \_\_\_\_\_

### Dimensions

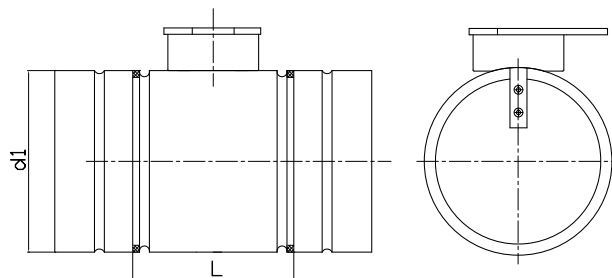

Product code	d <sub>1</sub> [mm]	L [mm]
FLX-DAS-75	75	110
FLX-DAS-90	90	110