



# Flow1000

*Top-class decentralised ventilation  
for retrofitting existing buildings*

Flow1000, the latest addition to the HRV Community family, was created to meet the need for optimal air exchange in all **very crowded locations** – such as classrooms, kindergartens, leisure facilities, shared offices, co-working spaces, shops, canteens – where it is essential to have high air quality without sacrificing comfort and energy saving. With **variable airflow of up to 1000 m<sup>3</sup>/h**, it is ideal for integrating a decentralised HRV system into existing buildings without resorting to complex and invasive masonry work, while minimising ductwork and installation time. Flow1000 is available not only as **HRV unit only** but as **Flow1000**

**Steel** – with white-painted steel cover, for visible installation – **Flow1000 Silent** – with white-painted wooden masking cover for ceiling installations – and **FlowM1000** with vertical white wooden cabinet structure. Features include **80% heat recovery** efficiency, excellent air purification capabilities with Coarse 80% + ePM1 80% filters. **Ease of maintenance** makes it the ideal solution for a HRV retrofits with no trade-offs. The installation requires two 250 mm coring holes in the external wall for the air supply and exhaust flows; it can also be managed by means of 4 x 125 mm conduits using accessories.

*Even greater  
sanitisation with  
ionisation*

To enhance indoor air purification, the Flow1000 Silent and M1000 versions can accommodate an energy-efficient active sanitising device that generates **bipolar ions**, developed to provide confined indoor environments with the air quality found in nature. **The combined action of air dilution, filtration and sanitisation** reduces the risks of airborne distribution of microbial, bacterial and viral loads.

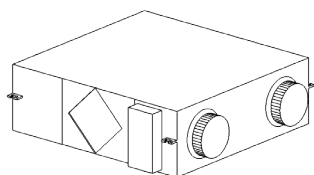

**Flow1000**  
HRV unit

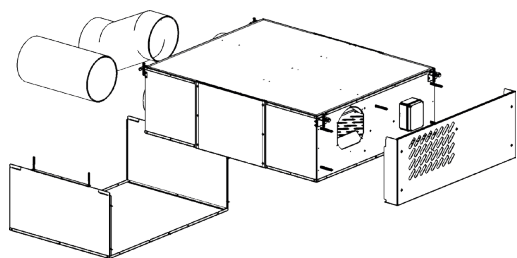

**Flow1000<sup>Steel</sup>**  
Ceiling installation

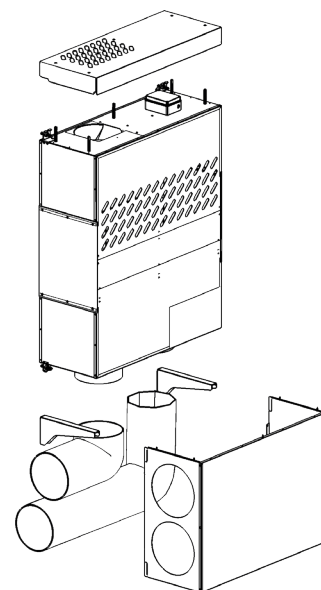

**Flow1000<sup>Steel</sup>**  
Wall-mounted installation

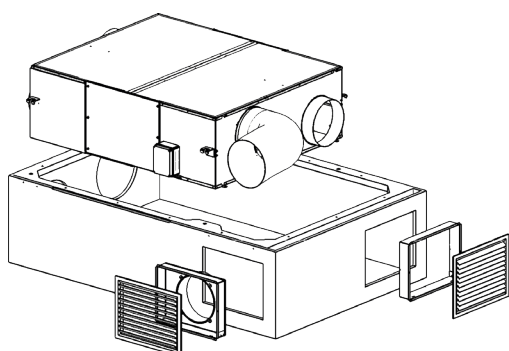

**Flow1000<sup>Silent</sup>**  
HRV with wooden cover for  
ceiling installation

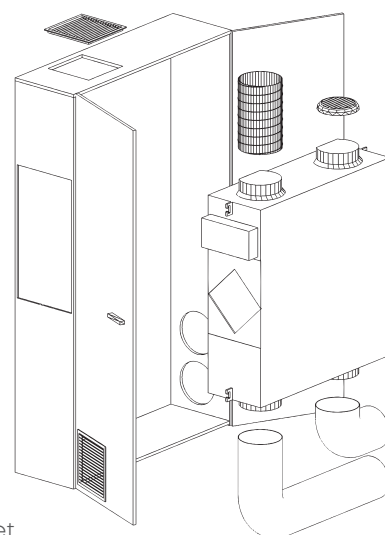

**FlowM1000**  
HRV in wooden cabinet



**80%**

Heat recovery  
efficiency



**21.5** dB(A)

Sound pressure



**1000** m<sup>3</sup>/h

Maximum airflow



**ISO Coarse 80%  
+ ePM1 80%**

Intake air filtration



**-40.4** kWh/m<sup>2</sup>a

SEC energy consumption  
(temperate climate)

Classe  
Energetica

**A**

## Technical data

Functions and features	UOM	Flow1000		Flow1000 <sup>Steel</sup>	
		STD	Pure	STD	Pure
Version					
Night function		●	●	●	●
Hyperventilation		●	●	●	●
Filter replacement alert		●	●	●	●
Humidity sensor		-	●	-	●
CO <sub>2</sub> and VOC sensor		-	●	-	●
Free Cooling		●	●	●	●
Control panel Removable STD		optional	optional	optional	optional
Control panel Removable cloud		optional	optional	optional	optional
On/Off LED panel		●	●	●	●
Helty Home app <sup>(1)</sup>		optional	optional	optional	optional
HCloud connection <sup>(1)</sup>		optional	optional	optional	optional
Airflow rate	m <sup>3</sup> /h	300/400/550/700/850/1000 <sup>(2)</sup>			
Flow adjustment		night + 4 stages + hyperventilation			
Power consumption	W	25/44/77/130/210/320 <sup>(2)</sup>			
Supply voltage	V AC	230			
Max. current consumption <sup>(3)</sup>	A	1.7			
HRV unit weight	kg	73		75	
HRV unit dimensions (W x H x D)	mm	1320 x 392 x 1020		1374 x 395 x 1024	
Heat exchanger		enthalpy cross-flow			
Heat recovery efficiency	%	80			
Bypass (free cooling/free heating)		manual electronic			
Sound power level <sup>(4)</sup>	dB(A)	37.2/41.7/48.7/57.7/59.2/60.7 <sup>(2)</sup>		44/48/55/59/64.8/68 <sup>(2)</sup>	
Sound pressure <sup>(5)</sup>	dB(A)	21.5/26/33/42/43.5/45 <sup>(2)</sup>		29/34/40/45/50/54 <sup>(2)</sup>	
Intake filter		ISO Coarse 80% + ePM1 80%			
Extraction filter		ISO Coarse 80%			
Modbus RTU rs485		Yes <sup>(8)</sup>			
Reference climate		cold / temperate / warm			
Energy efficiency class (cold / temperate / hot)		A+ / A / E			
SEC (cold / temperate / warm) <sup>(6)</sup>	kWh/m <sup>2</sup> a	-76.0 / -40.4 / -17.3			
Internal leakage <sup>(7)</sup>	%	2			
External leakage <sup>(7)</sup>	%	1			
Rated external pressure Δps. ext <sup>(6)</sup>	Pa	340		130	
Internal pressure drop Δps.int <sup>(6)</sup>	Pa	800		700	
Energy performance filters <sup>(6)</sup>		A+			
Kit		installation manual, HRV filters		installation manual, HRV filters	
Code		1VMC04016	1VMC04017	1VMC04025	1VMC04026

1. Cloud control panel connection required  
 2. In hyperventilation mode  
 3. With 230 V AC supply voltage

4. According to UNI 3744:2010  
 5. Measured 1 m below the unit, corrected with background noise and reverberation times

6. According to Regulation (EU) No. 1253/2014  
 7. In accordance with EN 13141-8:2014-09  
 8. The Cloud control panel functions are lost

## Technical data

Functions and features	UOM	Flow1000 <sup>Silent</sup>		FlowM1000				
		STD	Pure	LH STD	LH Pure	RH STD	RH Pure	
Version								
Night function		●	●	●	●	●	●	
Hyperventilation		●	●	●	●	●	●	
Filter replacement alert		●	●	●	●	●	●	
Humidity sensor		-	●	-	●	-	●	
CO <sub>2</sub> and VOC sensor		-	●	-	●	-	●	
Free Cooling		●	●	●	●	●	●	
Control panel Removable STD		optional	optional	optional	optional	optional	optional	
Control panel Removable cloud		optional	optional	optional	optional	optional	optional	
On/Off LED panel		●	●	●	●	●	●	
Hely Home app <sup>(7)</sup>		optional	optional	optional	optional	optional	optional	
HCloud connection <sup>(7)</sup>		optional	optional	optional	optional	optional	optional	
Airflow rate	m <sup>3</sup> /h	300/400/550/700/850/1000						
Flow adjustment		night + 4 stages + hyperventilation						
Power consumption	W	25/44/77/130/210/320						
Supply voltage	V AC	230						
Max. current consumption <sup>(2)</sup>	A	17						
HRV unit weight	kg	73						
Wooden cover weight	kg	60		-				
FlowM cabinet weight	kg	-		93				
HRV unit dimensions (W x H x D)	mm	1320 x 392 x 1020		1374 x 395 x 1024				
Wooden cover dimensions (W x H x D)	mm	1797 x 475 x 1213		-				
FlowM cabinet dimensions (W x H x D)	mm	-		1236 x 2400 x 450				
Heat exchanger		enthalpy cross-flow						
Heat recovery efficiency	%	80						
Bypass (free cooling/free heating)		manual electronic						
Sound power level <sup>(3)</sup>	dB(A)	37.2/41.7/48.7/57.7/59.2/60.7						
Sound pressure <sup>(5)</sup>	dB(A)	21.5/26/33/42/43.5/45						
Intake filter		ISO Coarse 80% + ePM1 80%						
Extraction filter		ISO Coarse 80%						
Modbus RTU rs485		Yes <sup>(8)</sup>						
Reference climate		cold / temperate / warm						
Energy efficiency class (cold / temperate / hot)		A+ / A / E						
SEC (cold / temperate / warm) <sup>(6)</sup>	kWh/m <sup>2</sup> a	-76.0 / -40.4 / -17.3						
Internal leakage <sup>(4)</sup>	%	2						
External leakage <sup>(4)</sup>	%	1						
Rated external pressure Δps. ext <sup>(4)</sup>	Pa	430						
Internal pressure drop Δps.int <sup>(4)</sup>	Pa	800						
Energy performance filters <sup>(6)</sup>		A+						
Kit		installation manual, ceiling cabinet with intake and extraction grills, support frame, HRV filters			installation manual, cabinet housing with doors, extraction and intake grills, support brackets, HRV filters			
Code		1VMC04018	1VMC04019	1VMC01053	1VMC01054	1VMC01051	1VMC01052	

1. In hyperventilation mode  
 2. With 230 V AC supply voltage  
 3. According to UNI 3744:2010

4. In accordance with EN 13141-8:2014-09  
 5. Measured 1 m below the unit. Correct with background noise and reverberation times

6. According to Regulation (EU) No. 1253/2014  
 7. Cloud control panel connection required  
 8. The Cloud control panel functions are lost

.....

## Accessories and spare parts

Article	Type	Code
Flow600/800/1000 template	Accessories	4VMC00000823
External grills 340x340 mm plastic	Accessories	1VMC99083
External horizontal stainless-steel grills	Accessories	1VMC99084
Exterior vertical stainless-steel grills	Accessories	1VMC99097
ISO flex tube Ø127 mm L 5m + x2 clamps	Accessories	1VMC99086
ISO flex tube Ø254 mm L 5m + x2 clamps	Accessories	1VMC99085
Tube adapter 120x60 mm Ø125 mm x4	Accessories	1VMC99091
Flow800/1000 side casing	Accessories	1VMC99073
Flow800/1000 ceiling casing	Accessories	1VMC99074
Flow800/1000 rear casing	Accessories	1VMC99111
Flow800/1000 Steel pre-heater	Accessories	1VMC99149A
Flow600/800/1000 Steel post-heater	Accessories	1VMC99094
Flow800/1000M post-heater	Accessories	1VMC99101
Flow800/1000 Silent post-heater	Accessories	1VMC99088
STD flush-mounted control panel + 5m cable	Accessories	1VMC06006
Cloud recessed control panel + 5m cable	Accessories	1VMC06011
External control panel box 503	Accessories	1VMC99078
Steel ionizer	Accessories	1VMC99089
Flow800/1000M and Silent ionizer	Accessories	1VMC99090
CO <sub>2</sub> monitor <sup>(1)</sup>	Accessories	4VMC00000902
IAQ monitor <sup>(1)</sup>	Accessories	4VMC00000903
Coarse filter pre-heater	Filters	1VMC99162
Coarse filter pre-heater x10	Filters	1VMC99163
Filter ePM1 80% + Coarse80%Flow800	Filters	1VMC99050
ePM1 80% + Coarse 80% Flow800 x10 filter	Filters	1VMC99061

1. Cloud Control Panel required

# Flow-head charts

- A Head
- B Flow rate
- 1 Super-minimum speed (night)
- 2 Speed 1
- 3 Speed 2
- 4 Speed 3
- 5 Speed 4
- 6 Hyperventilation

## Flow1000<sup>Steel</sup>

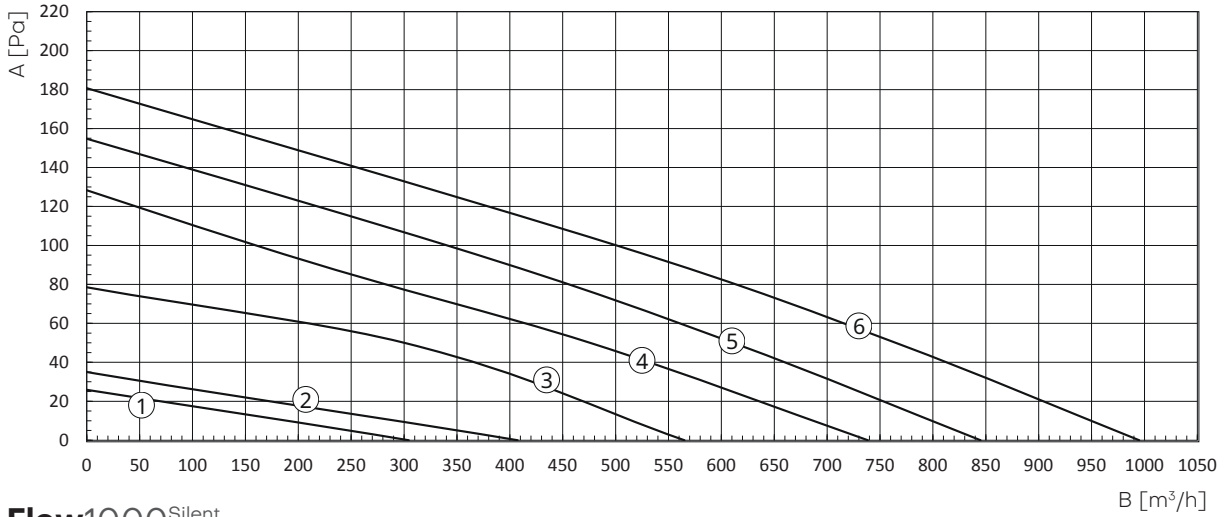

## Flow1000<sup>Silent</sup>

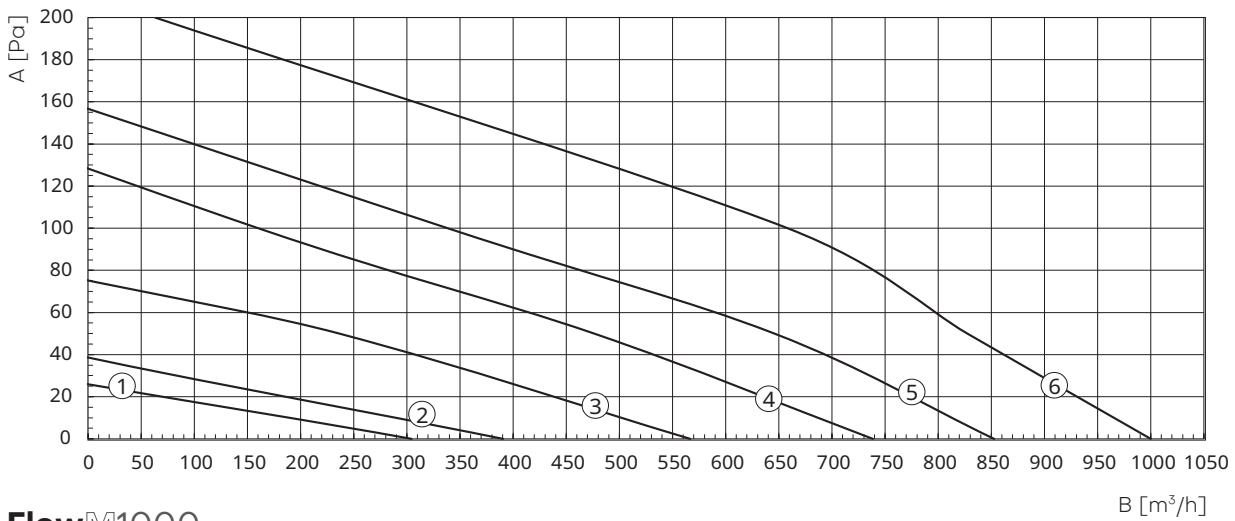

## FlowM1000

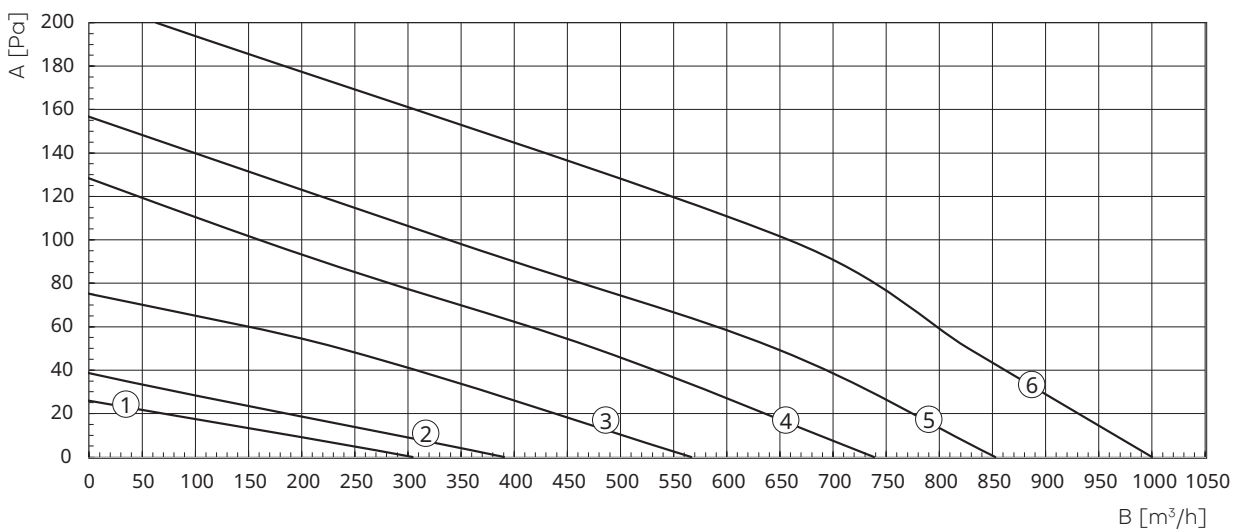

.....

## Dimensional drawings

### Flow1000<sup>Steel</sup>

Wall-mounted installation

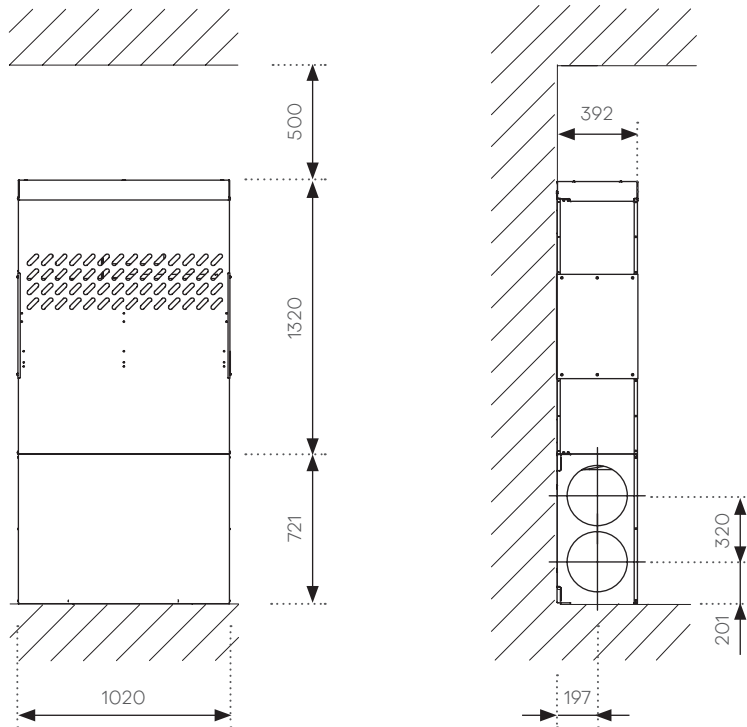

### Flow1000<sup>Steel</sup>

Ceiling installation

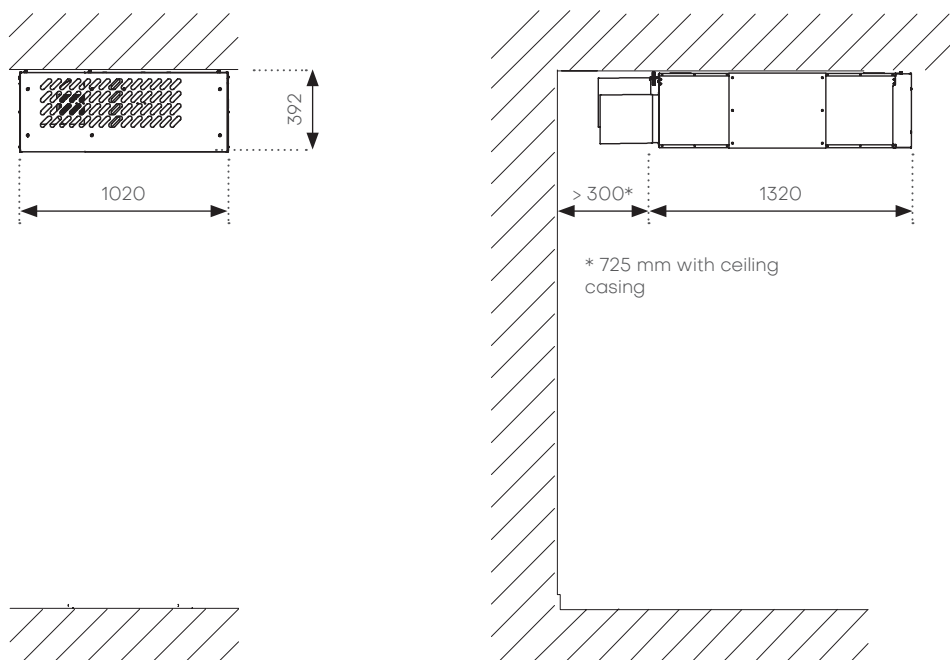

## Dimensional drawings

**Flow1000<sup>Silent</sup>**  
 HRV with wooden cover for  
 ceiling installation

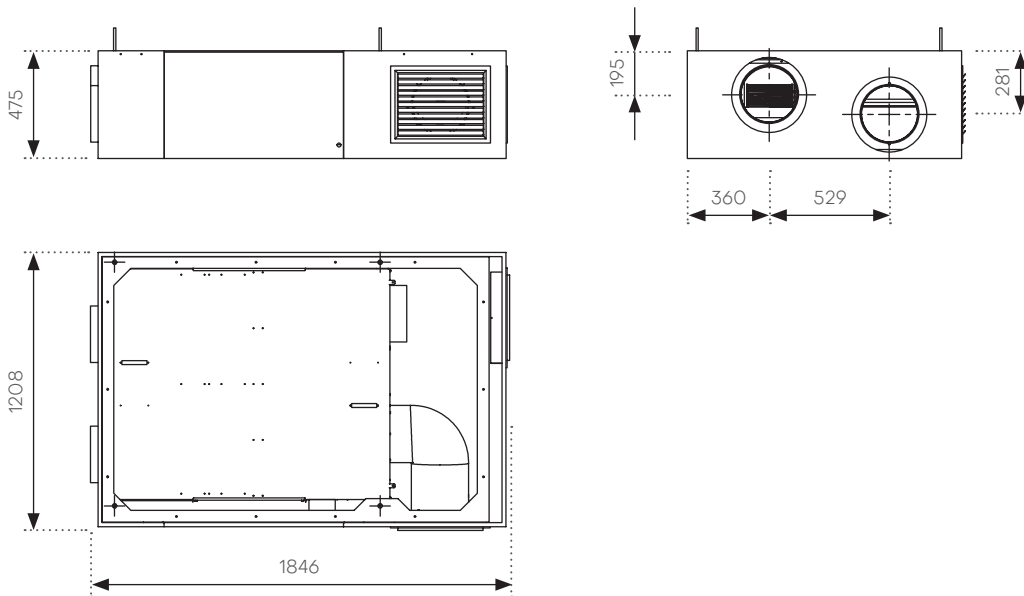

**FlowM1000 - left side**  
 HRV in wooden cabinet

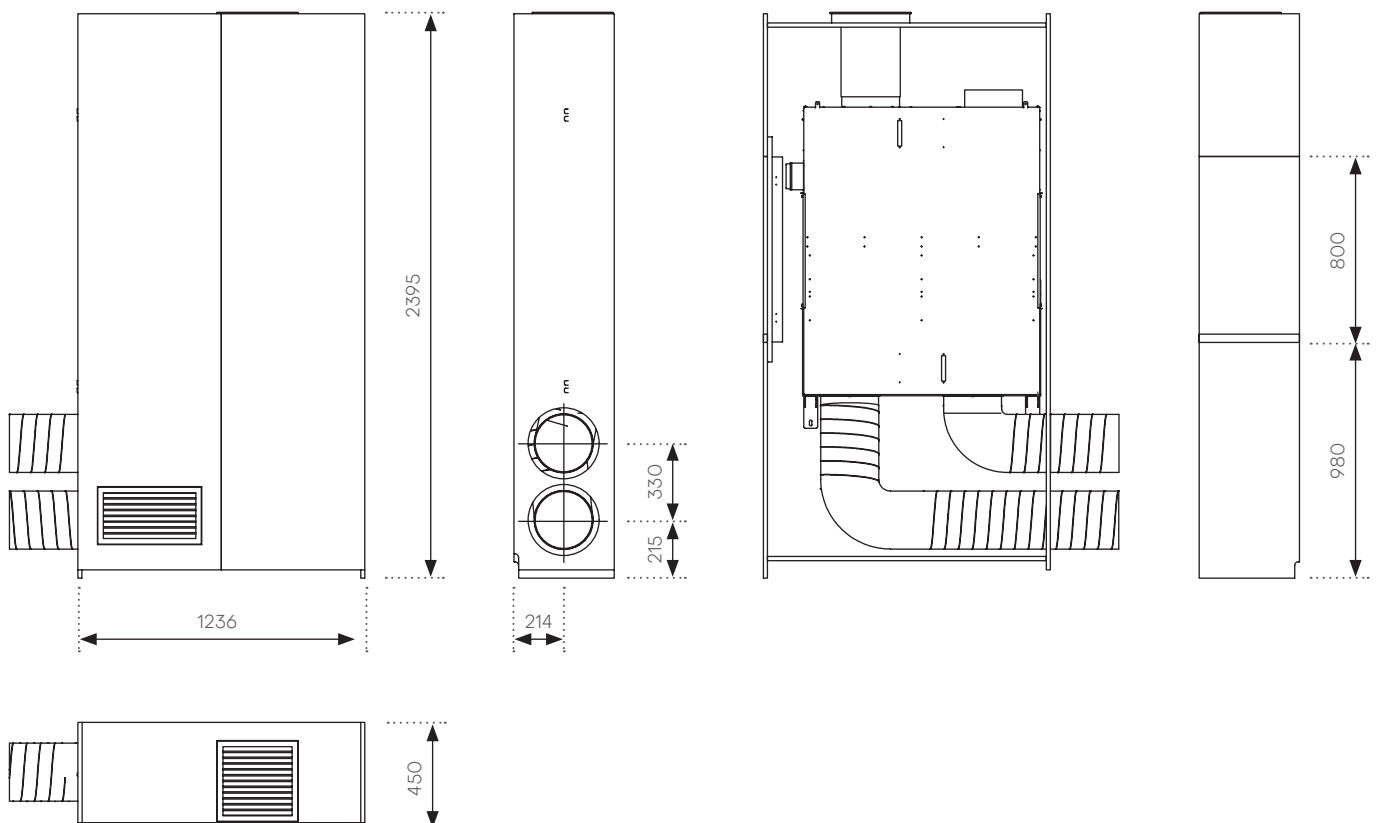



.....



## Dimensional drawings

### FlowM1000 – right side HRV in wooden cabinet

