



Flow800/800-R

High air exchange without sacrificing aesthetics and acoustics

High-performing and quiet, Flow800 is now updated and expands its family with new versions to respond in full to the needs of designers and customers.

The range features new versions alongside the HRV unit, ideal for false ceiling applications, such as **Flow800 Steel**, where the HRV is natively integrated into a white painted steel cover for visible installations and suitable for ceiling and wall installations. **Flow800 Silent**, completed by a white wood cosmetic cover, for ceiling installations requiring **minimised aesthetic and acoustic impact of the HRV and FlowM800**, where the ventilation unit is made totally invisible by camouflaging it on

a white cabinet offering ease of integration in environments and great simplicity of access to the unit for inspections and filter changes. The airflow can be modulated over 6 values, from 300 m³/h (minimum speed in night mode) up to **800 m³/h** (maximum speed in hyperventilation), by means of the panel featuring Helty's standard user-friendly control interface. A control panel for recessed installation in 503 electrical boxes is also available as an accessory. The enthalpy heat exchanger ensures **80% heat exchange efficiency**, while the **dual Coarse 80% + ePM1 80% filter** stops approximately 90% of PM10 and 80% of PM2.5 by bringing oxygenated and purified air inside.



IAQ sensors and effective action against radon

Flow800 is also available in a Pure version, with **hygrometric sensor and CO₂ and VOC sensors** that allow the HRV unit to monitor humidity and indoor pollutant parameters, automatically adjusting the air exchange as needed. The **Flow800-R** version is designed to restore **radon gas concentration to optimal values**, restoring healthy environments and helping to mitigate risk.

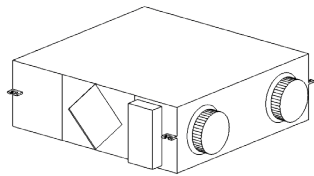

Flow800
HRV unit

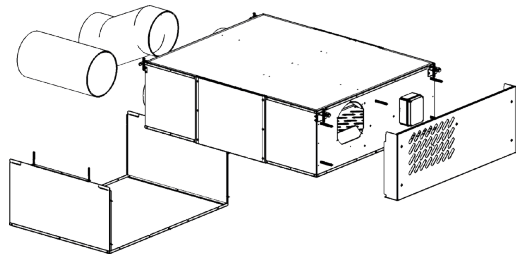

Flow800^{Steel}
Ceiling installation

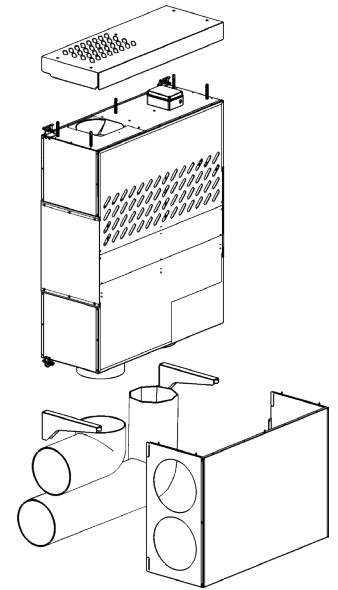

Flow800^{Steel}
Wall-mounted installation

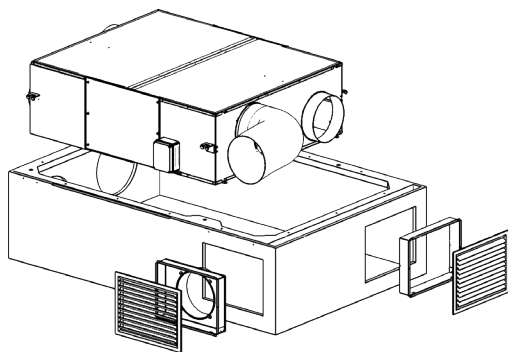

Flow800^{Silent}
HRV with wooden cover for
ceiling installation

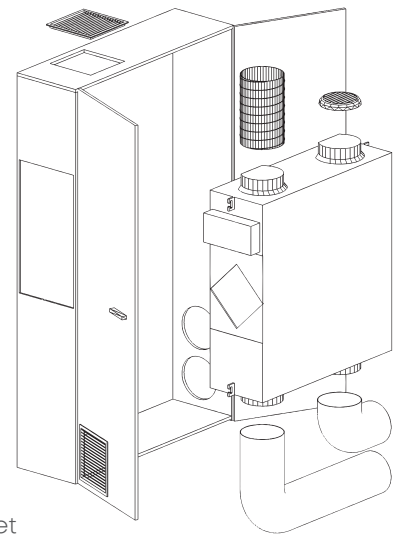

FlowM800
HRV in wooden cabinet



80%

Heat recovery
efficiency



21.5 dB(A)

Sound pressure



800 m³/h

Maximum airflow



**ISO Coarse 80%
+ ePM1 80%**

Intake air filtration



-41.3 kWh/m²a

SEC energy consumption
(temperate climate)



Scan the QR Code to
view the case histories

Classe
Energetica

A

Technical data

Functions and features	UOM	Flow800		Flow800 ^{Steel}		
		STD	Pure	STD	Pure	R 
Version						
Night function		●	●	●	●	●
Hyperventilation		●	●	●	●	●
Filter replacement alert		●	●	●	●	●
Humidity sensor		-	●	-	●	-
CO ₂ and VOC sensor		-	●	-	●	-
Radon scenario		-	-	-	-	●
Radon sensor ⁽¹⁾		-	-	-	-	optional
Free Cooling		●	●	●	●	●
Control panel Removable STD		optional	optional	optional	optional	-
Control panel Removable cloud		optional	optional	optional	optional	●
On/Off LED panel		●	●	●	●	●
Helty Home app ⁽¹⁾		optional	optional	optional	optional	●
HCloud connection ⁽¹⁾		optional	optional	optional	optional	●
Airflow rate	m ³ /h	300/350/500/600/700/800 ⁽²⁾				
Flow adjustment		night + 4 stages + hyperventilation				
Power consumption	W	22/26/46/61/90/138 ⁽²⁾				
Supply voltage	V AC	230				
Max. current consumption ⁽³⁾	A	0.7				
HRV unit weight	kg	73		75		
HRV unit dimensions (W x H x D)	mm	1320 x 392 x 1020		1374 x 395 x 1024		
Heat exchanger		enthalpy cross-flow				
Heat recovery efficiency	%	80				
Bypass (free cooling/free heating)		manual electronic				
Sound power level ⁽⁴⁾	dB(A)	37.2/39.7/46.7/53.3/57.7/58.7 ⁽²⁾		43.5/46.2/54.9/56.9/59.4/64.4 ⁽²⁾		
Sound pressure ⁽⁵⁾	dB(A)	21.5/24/31/37.6/42/43 ⁽²⁾		28.6/31.3/40/42/44.5/49.5 ⁽²⁾		
Intake filter		ISO Coarse 80% + ePM1 80%				
Extraction filter		ISO Coarse 80%				
Modbus RTU rs485		Yes ⁽⁸⁾				
Reference climate		cold / temperate / warm				
Energy efficiency class (cold / temperate / hot)		A+ / A / E				
SEC (cold / temperate / warm) ⁽⁶⁾	kWh/m ² a	-77.1 / -41.3 / -18.1				
Internal leakage ⁽⁷⁾	%	2				
External leakage ⁽⁷⁾	%	1				
Rated external pressure Δps.ext ⁽⁶⁾	Pa	300		150		
Internal pressure drop Δps.int ⁽⁶⁾	Pa	420		340		
Energy performance filters ⁽⁶⁾		A+				
Kit		installation manual, HRV filters		installation manual, HRV filters		installation manual, user manual, control panel, HRV filters
Code		1VMC04010	1VMC04022	1VMC04021	1VMC04012	1VMC04027

1. Cloud control panel connection required
 2. In hyperventilation mode
 3. With 230 V AC supply voltage

4. According to UNI 3744:2010
 5. Measured 1 m below the unit, corrected with background noise and reverberation times

6. According to Regulation (EU) No. 1253/2014
 7. In accordance with EN 13141-8:2014-09
 8. The Cloud control panel functions are lost

Technical data

Functions and features	UOM	Flow800 ^{Silent}		FlowM800				
		STD	Pure	LH STD	LH Pure	RH STD	RH Pure	
Version								
Night function		●	●	●	●	●	●	
Hyperventilation		●	●	●	●	●	●	
Filter replacement alert		●	●	●	●	●	●	
Humidity sensor		-	●	-	●	-	●	
CO ₂ and VOC sensor		-	●	-	●	-	●	
Free Cooling		●	●	●	●	●	●	
Control panel Removable STD		optional	optional	optional	optional	optional	optional	
Control panel Removable cloud		optional	optional	optional	optional	optional	optional	
On/Off LED panel		●	●	●	●	●	●	
Hely Home app ⁽¹⁾		optional	optional	optional	optional	optional	optional	
HCloud connection ⁽¹⁾		optional	optional	optional	optional	optional	optional	
Airflow rate	m ³ /h	300/350/500/600/700/800 ⁽²⁾						
Flow adjustment		night + 4 stages + hyperventilation						
Power consumption	W	22/26/46/61/90/138 ⁽²⁾						
Supply voltage	V AC	230						
Max. current consumption ⁽³⁾	A	0.7						
HRV unit weight	kg	73						
Wooden cover weight	kg	60		-				
FlowM cabinet weight	kg	-		93				
HRV unit dimensions (W x H x D)	mm	1320 x 392 x 1020		1374 x 395 x 1024				
Wooden cover dimensions (W x H x D)	mm	1797 x 475 x 1213		-				
FlowM cabinet dimensions (W x H x D)	mm	-		1236 x 2400 x 450				
Heat exchanger		enthalpy cross-flow						
Heat recovery efficiency	%	80						
Bypass (free cooling/free heating)		manual electronic						
Sound power level ⁽⁴⁾	dB(A)	37.2/39.7/46.7/53.3/57.7/58.7 ⁽²⁾						
Sound pressure ⁽⁵⁾	dB(A)	21.5/24/31/37.6/42/43 ⁽²⁾						
Intake filter		ISO Coarse 80% + ePM1 80%						
Extraction filter		ISO Coarse 80%						
Modbus RTU rs485		Yes ⁽⁸⁾						
Reference climate		cold / temperate / warm						
Energy efficiency class (cold / temperate / hot)		A+ / A / E						
SEC (cold / temperate / warm) ⁽⁶⁾	kWh/m ² a	-77.1 / -41.3 / -18.1						
Internal leakage ⁽⁷⁾	%	2						
External leakage ⁽⁷⁾	%	1						
Rated external pressure Δps. ext ⁽⁶⁾	Pa	300						
Internal pressure drop Δps.int ⁽⁶⁾	Pa	420						
Energy performance filters ⁽⁶⁾		A+						
Kit		installation manual, ceiling cabinet with intake and extraction grills, support frame, HRV filters			installation manual, cabinet housing with doors, extraction and intake grills, support brackets, HRV filters			
Code		1VMC04023	1VMC04024	1VMC01048	1VMC01055	1VMC01047	1VMC01056	

1. In hyperventilation mode
 2. With 230 V AC supply voltage
 3. According to UNI 3744:2010

4. In accordance with EN 13141-8:2014-09
 5. Measured 1 m below the unit. Correct with background noise and reverberation times

6. According to Regulation (EU) No. 1253/2014
 7. Cloud control panel connection required
 8. The Cloud control panel functions are lost

.....

Accessories and spare parts

Article	Type	Code
External grills 340x340 mm plastic	Accessories	1VMC99083
External horizontal stainless-steel grills	Accessories	1VMC99084
Exterior vertical stainless-steel grills	Accessories	1VMC99097
Tube adapter 120x60 mm Ø125 mm x4	Accessories	1VMC99091
ISO flex tube Ø127 mm L 5m + x2 clamps	Accessories	1VMC99086
ISO flex tube Ø254 mm L 5m + x2 clamps	Accessories	1VMC99085
Flow800/1000 Steel pre-heater	Accessories	1VMC99149
Flow800/1000 Silent post-heater	Accessories	1VMC99088
Flow600/800/1000 Steel post-heater	Accessories	1VMC99094
Flow800/1000M post-heater	Accessories	1VMC99101
Flow800/1000M and Silent ionizer	Accessories	1VMC99090
STD flush-mounted control panel + 5 m cable	Accessories	1VMC06006
Cloud recessed control panel + 5 m cable	Accessories	1VMC06011
External control panel box 503	Accessories	1VMC99078
CO ₂ monitor ⁽¹⁾	Accessories	4VMC00000902
IAQ monitor ⁽¹⁾	Accessories	4VMC00000903
Coarse filter pre-heater	Filters	1VMC99162
Coarse filter pre-heater x10	Filters	1VMC99163
ePM1 80% + Coarse 80% Flow800 filter	Filters	1VMC99050
ePM1 80% + Coarse 80% Flow800 x10 filter	Filters	1VMC99061

1. Cloud Control Panel required

Flow-head charts

- A Head
- B Flow rate
- 1 Super-minimum speed (night)
- 2 Speed 1
- 3 Speed 2
- 4 Speed 3
- 5 Speed 4
- 6 Hyperventilation

Flow800^{Steel}

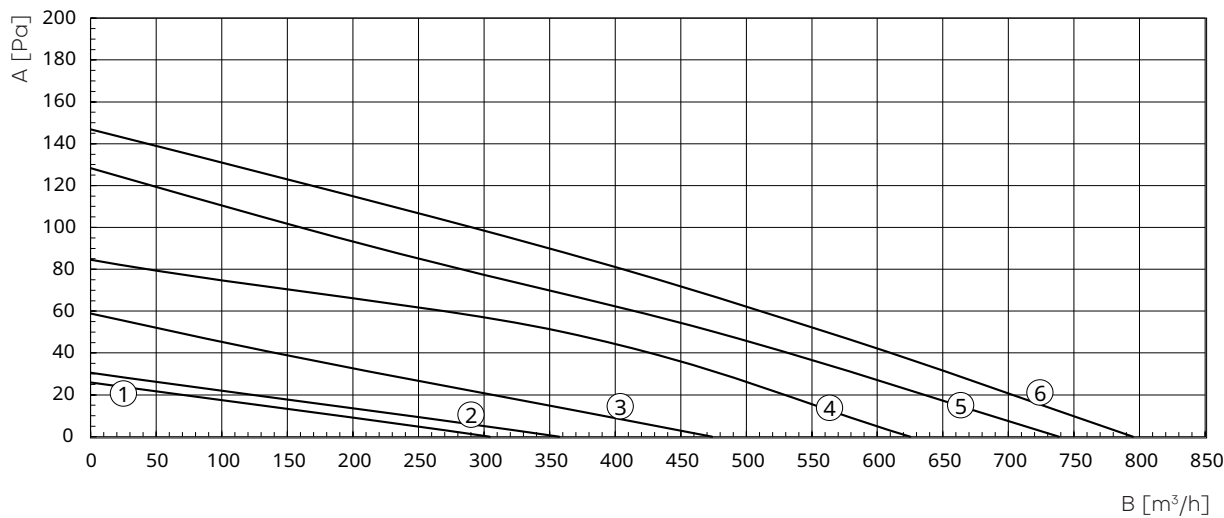

Flow800^{Silent}

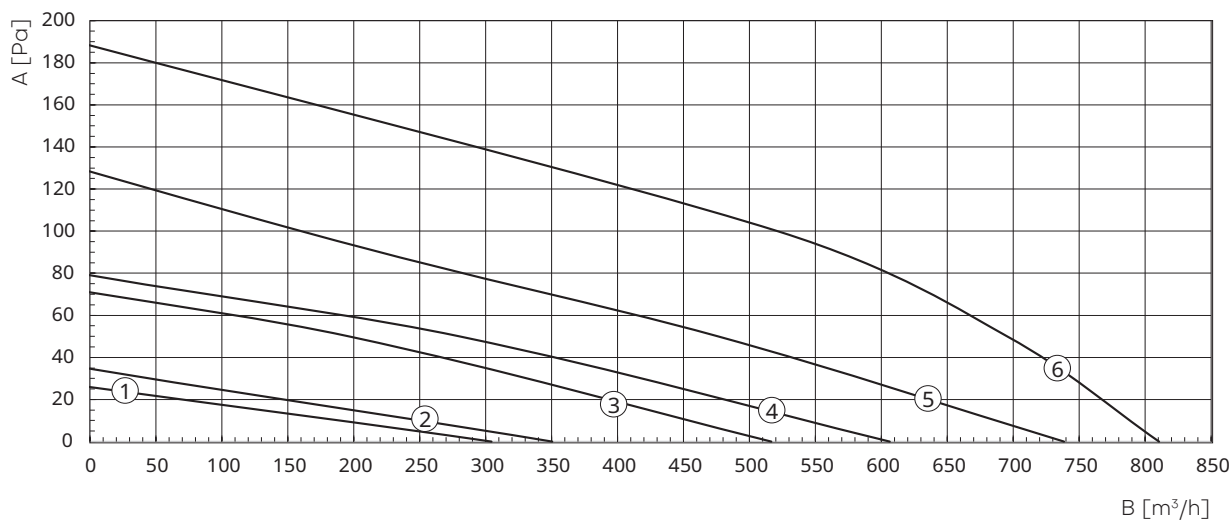

FlowM800

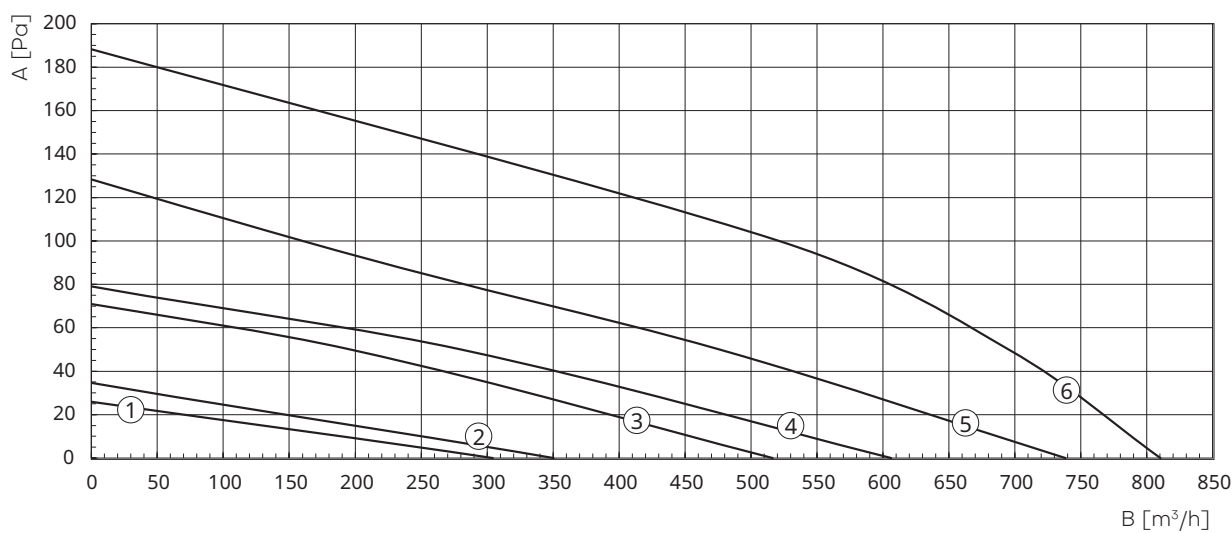

.....

Dimensional drawings

Flow800^{Steel}

Wall-mounted installation

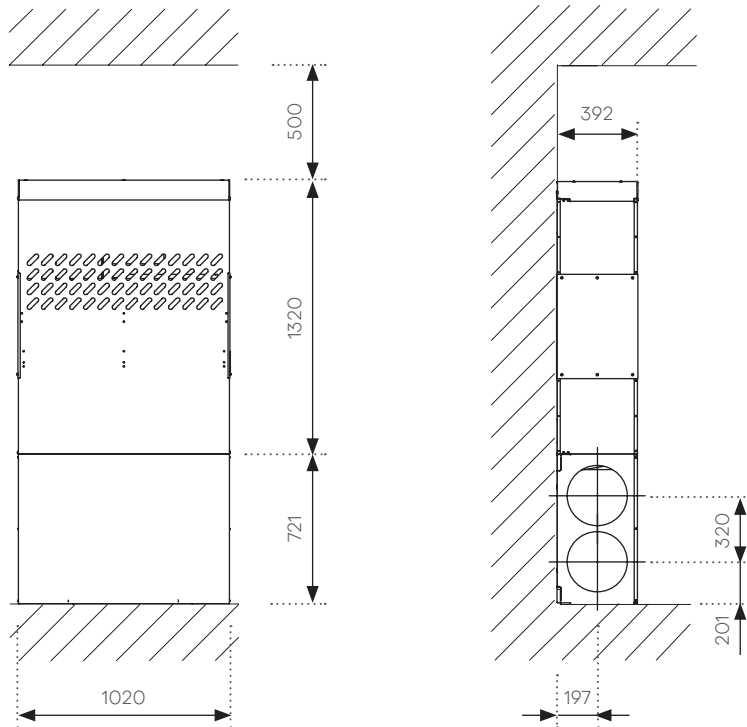

Flow800^{Steel}

Ceiling installation

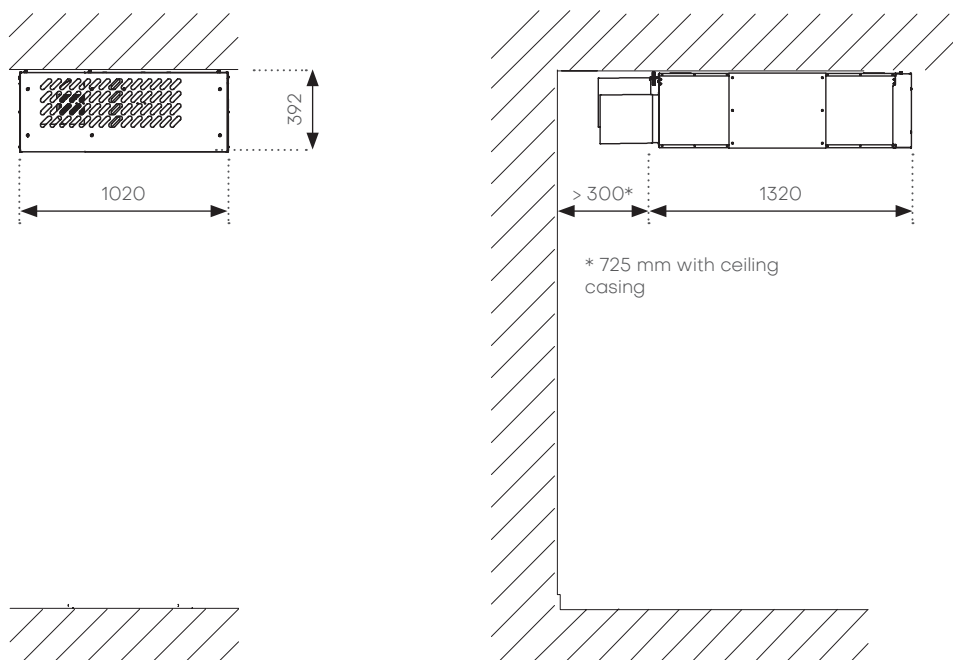

Dimensional drawings

Flow800^{Silent}
 HRV with wooden cover for
 ceiling installation

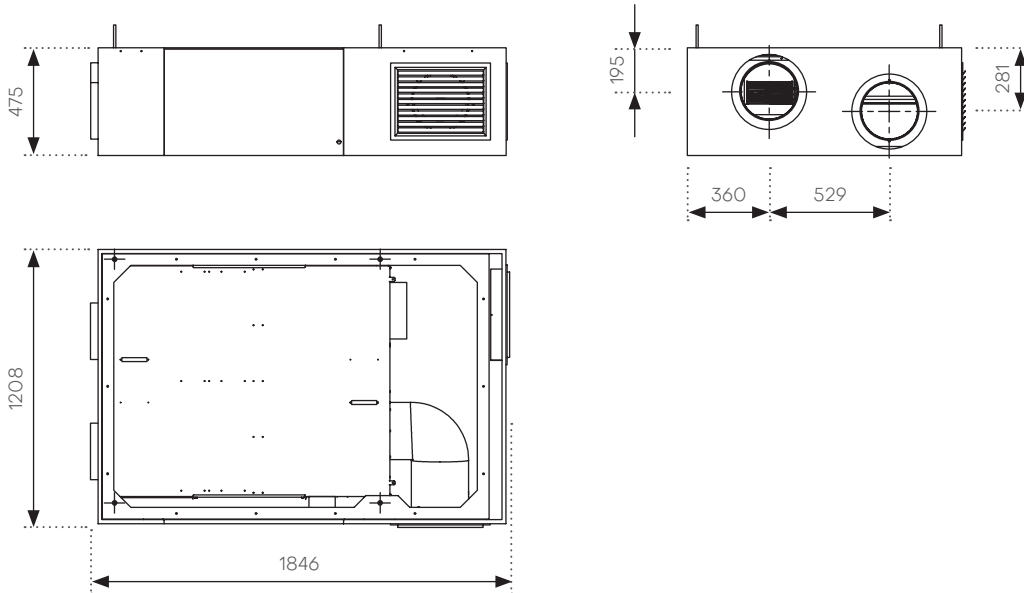

FlowM800 - left side
 HRV in wooden cabinet

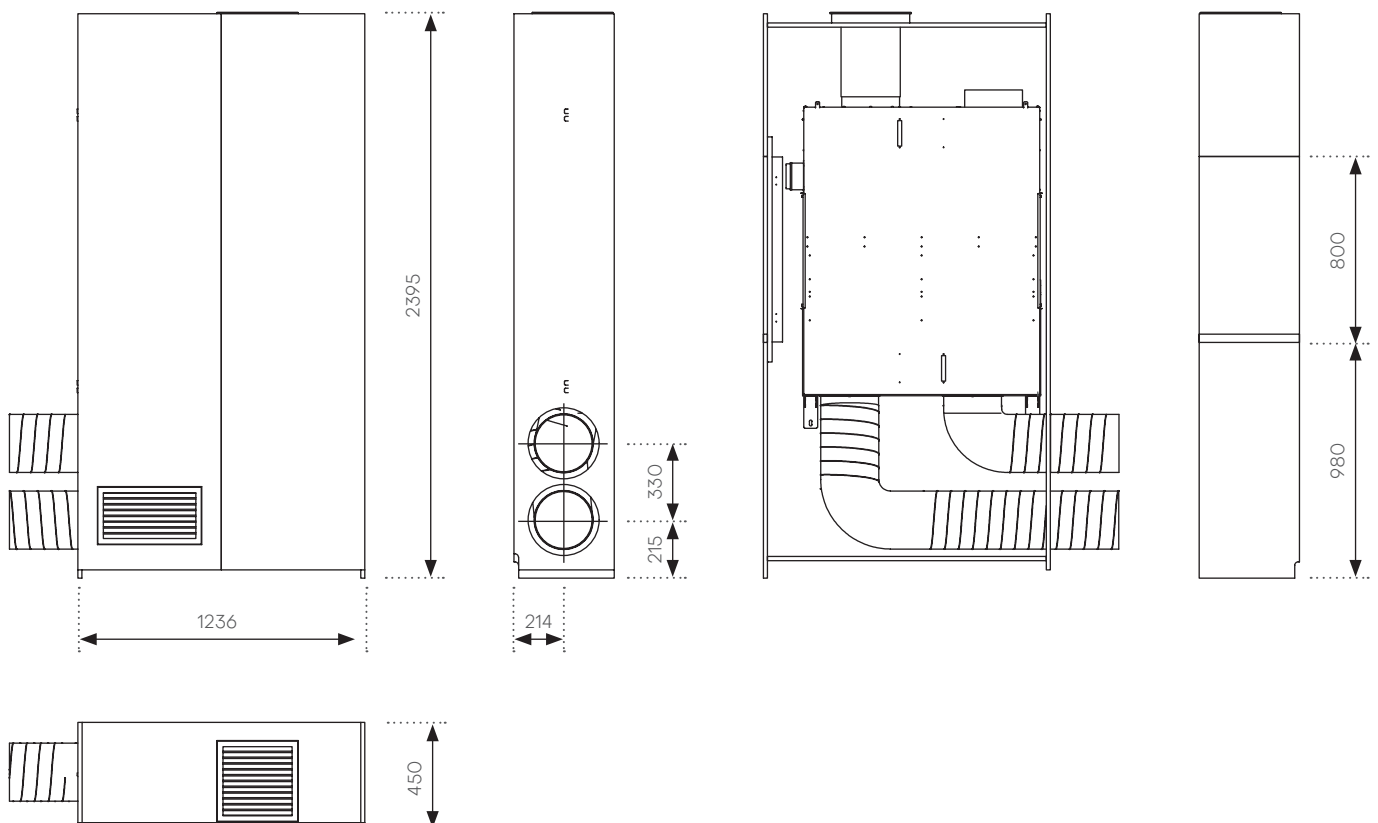

.....



Dimensional drawings

FlowM800 - right side
HRV in wooden cabinet

