



Flow600

Slim shape, versatile performance

Flow600 Steel is ideal for installation in reception areas, offices, schools and kindergartens. Flow 600 Steel allows modulation of air exchange on **variable flow rates from 250 m³/h** (minimum speed) **to 600 m³/h** (maximum speed in hyperventilation mode), with four intermediate flow rates to flexibly meet design needs requiring high air renewal rates in medium to high-crowded environments, such as classrooms. The unit is equipped with an enthalpy cross-flow heat exchanger, allowing **heat recovery efficiency of up to 82%**. No condensate drain preparation is required. The Coarse 80% + ePM1 80%

filter assembly fitted as standard ensures excellent filtration levels. The HRV unit is natively **integrated into a white painted steel cover**, complete with air intake and extraction openings, allowing the visible unit to be installed with no need for additional cosmetic covering. It can be **installed on the ceiling or as a vertical wall-mounted version** by means of a special tube casing, **allowing the intake/ extraction vents to be managed on either the right or left side**, so as to adapt to design requirements. **Two 200-mm** coring holes in the perimeter wall, or alternatively four 100 mm holes are sufficient.

IAQ sensors in the Pure version

In addition to the standard version, Flow600 Steel is also available in a Pure version with a hygrometric sensor and CO₂ and VOC sensor for monitoring essential occupant well-being parameters, such as relative humidity, carbon dioxide levels and volatile organic compounds. By detecting the values in real time, **the HRV can automatically adjust the air exchange according to the actual needs** read in the room to be ventilated.

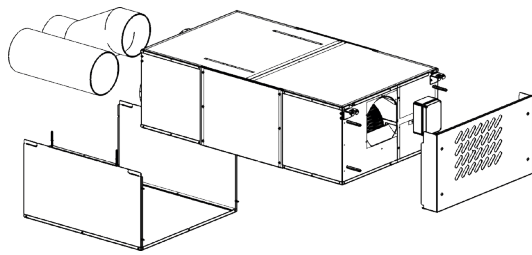

Flow600^{Steel}
Ceiling installation

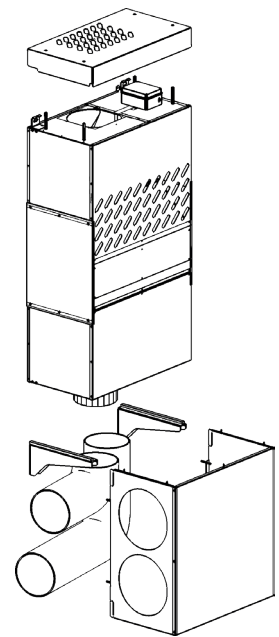

Flow600^{Steel}
Wall-mounted installation



82%

Heat recovery efficiency



35 dB(A)

Sound pressure



600 m³/h

Maximum airflow



**ISO Coarse 80%
+ ePM1 80%**

Intake air filtration



-40.6 kWh/m²a

SEC energy consumption (temperate climate)



Classe Energetica

A

Technical data

Functions and features	UOM	Flow600 ^{Steel}	
		STD	Pure
Version			
Night function		●	●
Hyperventilation		●	●
Filter replacement alert		●	●
Humidity sensor		-	●
CO ₂ and VOC sensor		-	●
Free Cooling		●	●
Control panel Removable STD		optional	optional
Control panel Removable cloud		optional	optional
On/Off LED panel		●	●
Helty Home app ⁽¹⁾		optional	optional
HCloud connection ⁽¹⁾		optional	optional
Airflow rate	m ³ /h	250/300/350/450/550/600 ⁽²⁾	
Flow adjustment		night + 4 stages + hyperventilation	
Power consumption	W	30/44/60/94/166/220 ⁽²⁾	
Supply voltage	V AC	230	
Max. current consumption ⁽³⁾	A	1	
Weight	kg	55	
Product dimensions (W x H x D)	mm	1374 x 395 x 706	
Heat exchanger		counter-flow enthalpy	
Heat recovery efficiency	%	82	
Bypass (free cooling/free heating)		manual electronic	
Sound power level ⁽⁴⁾	dB(A)	50/53/57/61/67/69 ⁽²⁾	
Sound pressure ⁽⁵⁾	dB(A)	35/39/43/47.4/52.5/55 ⁽²⁾	
Intake filter		ISO Coarse 80% + ePM1 80%	
Extraction filter		ISO Coarse 80%	
Modbus RTU rs485		Yes ⁽⁸⁾	
Reference climate		cold / temperate / warm	
Energy efficiency class (cold / temperate / hot)		A+ / A / E	
SEC (cold / temperate / warm) ⁽⁶⁾	kWh/m ² a	-76.8 / -40.6 / -17.2	
Internal leakage ⁽⁷⁾	%	2	
External leakage ⁽⁷⁾	%	0.5	
Rated external pressure Δps. ext ⁽⁶⁾	Pa	120	
Internal pressure drop Δps.int ⁽⁶⁾	Pa	360	
Energy performance filters ⁽⁶⁾		A+	
Kit		installation manual, HRV filters	
Code		1VMC04020	1VMC04015

1. Cloud control panel connection required
 2. In hyperventilation mode
 3. With 230 V AC supply voltage

4. According to UNI 3744:2010
 5. Measured 1 m below the unit, corrected with background noise and reverberation times

6. According to Regulation (EU) No. 1253/2014
 7. In accordance with EN 13141-8:2014-09
 8. The Cloud control panel functions are lost

Accessories and spare parts

Article	Type	Code
Flow600/800/1000 template	Accessories	4VMC00000823
External grills 340x340 mm plastic	Accessories	1VMC99083
External horizontal stainless-steel grills	Accessories	1VMC99084
Exterior vertical stainless-steel grills	Accessories	1VMC99097
ISO flex tube Ø102 mm L 5m + x2 clamps	Accessories	1VMC99087
ISO flex tube Ø203 mm L 5m + x2 clamps	Accessories	1VMC99093
Tube adapter 120x60 mm Ø100 mm x4	Accessories	1VMC99092
Flow600 side casing	Accessories	1VMC99081
Flow600 ceiling casing	Accessories	1VMC99082
Flow600 rear casing	Accessories	1VMC99112
RH outlet casing compatible with Flow600 heater	Accessories	1VMC99136
Rear outlet casing compatible with Flow600 heater	Accessories	1VMC99144
RH output ceiling casing compatible with Flow600 heater	Accessories	1VMC99166
Ceiling casing compatible with Flow600 heater	Accessories	1VMC99146
Flow600 Steel pre-heater	Accessories	1VMC99148
Flow600/800/1000 Steel post-heater	Accessories	1VMC99094
Flow600 Steel oversized post-heater	Accessories	1VMC99102
STD flush-mounted control panel + 5 m cable	Accessories	1VMC06006
Cloud recessed control panel + 5 m cable	Accessories	1VMC06011
External control panel box 503	Accessories	1VMC99078
Steel ionizer	Accessories	1VMC99089
CO ₂ monitor ⁽²⁾	Accessories	4VMC00000902
IAQ monitor ⁽²⁾	Accessories	4VMC00000903
Coarse filter pre-heater	Filters	1VMC99162
Coarse filter pre-heater x10	Filters	1VMC99163
ePM1 80% + Coarse 80% Flow600 filter	Filters	1VMC99080
ePM1 80% + Coarse 80% Flow600 x10 filter	Filters	1VMC99079

1. Cloud Control Panel required

Flow-head charts

A Head **1** Super-minimum speed (night) **3** Speed 2 **5** Speed 4
B Flow rate **2** Speed 1 **4** Speed 3 **6** Hyperventilation

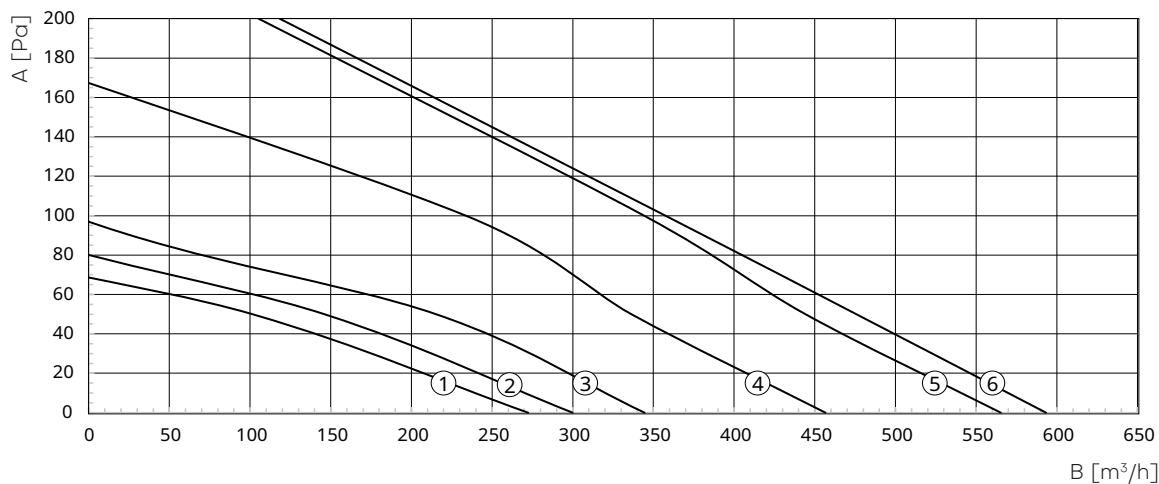

.....

Dimensional drawings

Flow600^{Steel}

Wall-mounted installation

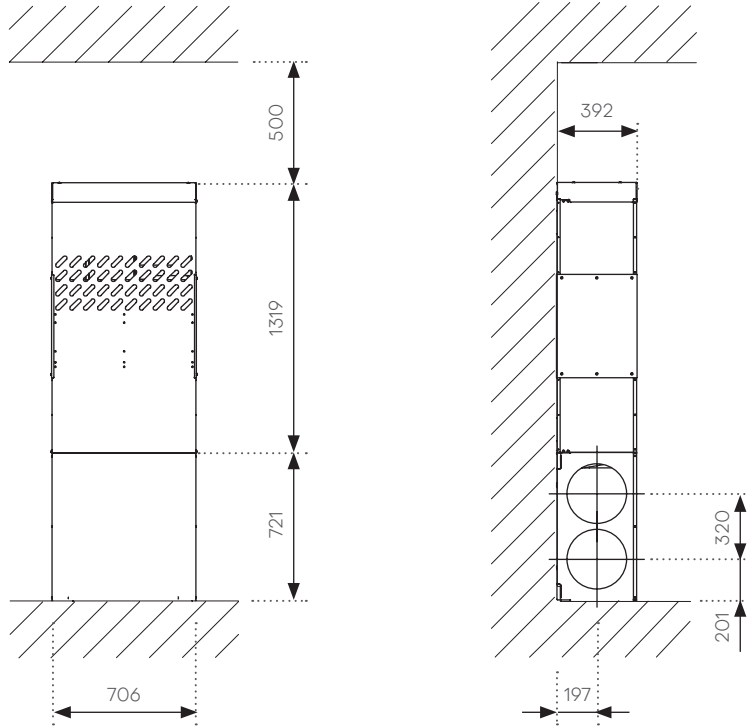

Flow600^{Steel}

Ceiling installation

